

County Deck Services

22 Louden rd
Saratoga Springs NY 12866

(518) 584 6170

www.countydeck.com











County Deck Services

22 Louden Rd
Saratoga Springs NY 12866
(518) 584 6170

Guarantee:

County Deck Services will replace or repair at no cost for Materials or Labor any material, which under normal use fails to function for which it is designed and/or may jeopardize the safety or well being of the property owner or guests or is deemed defective and falls under the Trex *limited material replacement 25 year guarantee.

This warrantee is good for **3 years** starting on the final inspection date on an approved inspection by the issuing agency.

** **Note:** Additional Labor protection is offered by the Trex company for an additional cost. please ask about this option if you are interested in additional labor protection as Trex warrantees the materials only for 25 years which does not include labor for replacement.*



References:

Viscusi Wholesale Grocers

Stanley and Elizabeth Gee

George and Lisa Muller

Hank Cooney

Mike Richards

Dave and Geri Romie

Chris & Alexia

Christina and Drew Serynek

Sarah and Eathan Plank

Schenectady

Malta

Wilton

Lake Placid, NY

Clifton Park NY

Wilton NY

Wilton NY

Ballston Spa NY

Greenfield Center

(518) 377-6814

(518) 584-1833

(518) 584-5368

<https://www.facebook.com/hank.cooney>

(518) 886 8044

(518) 312 2112

(518) 312-2993

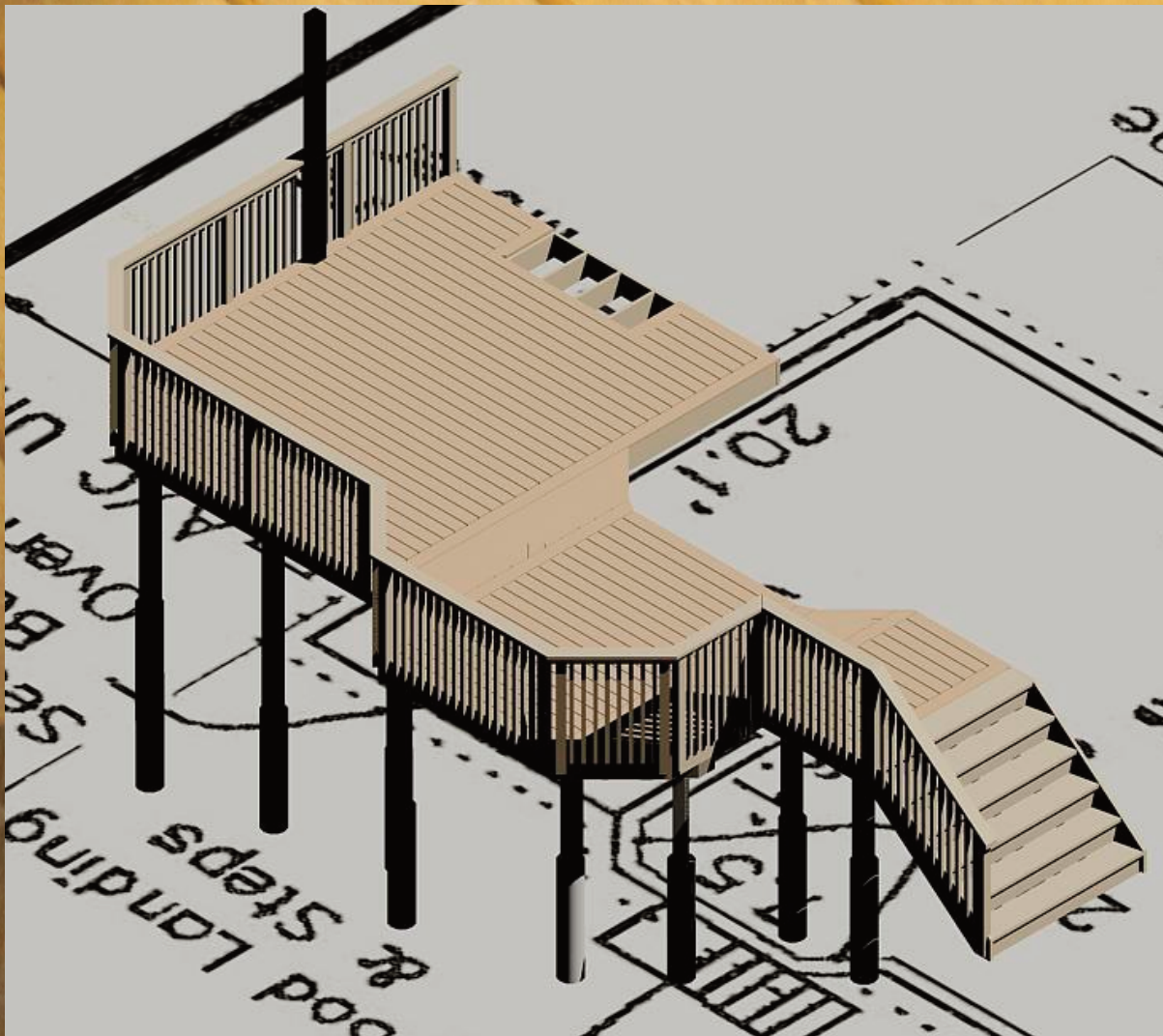

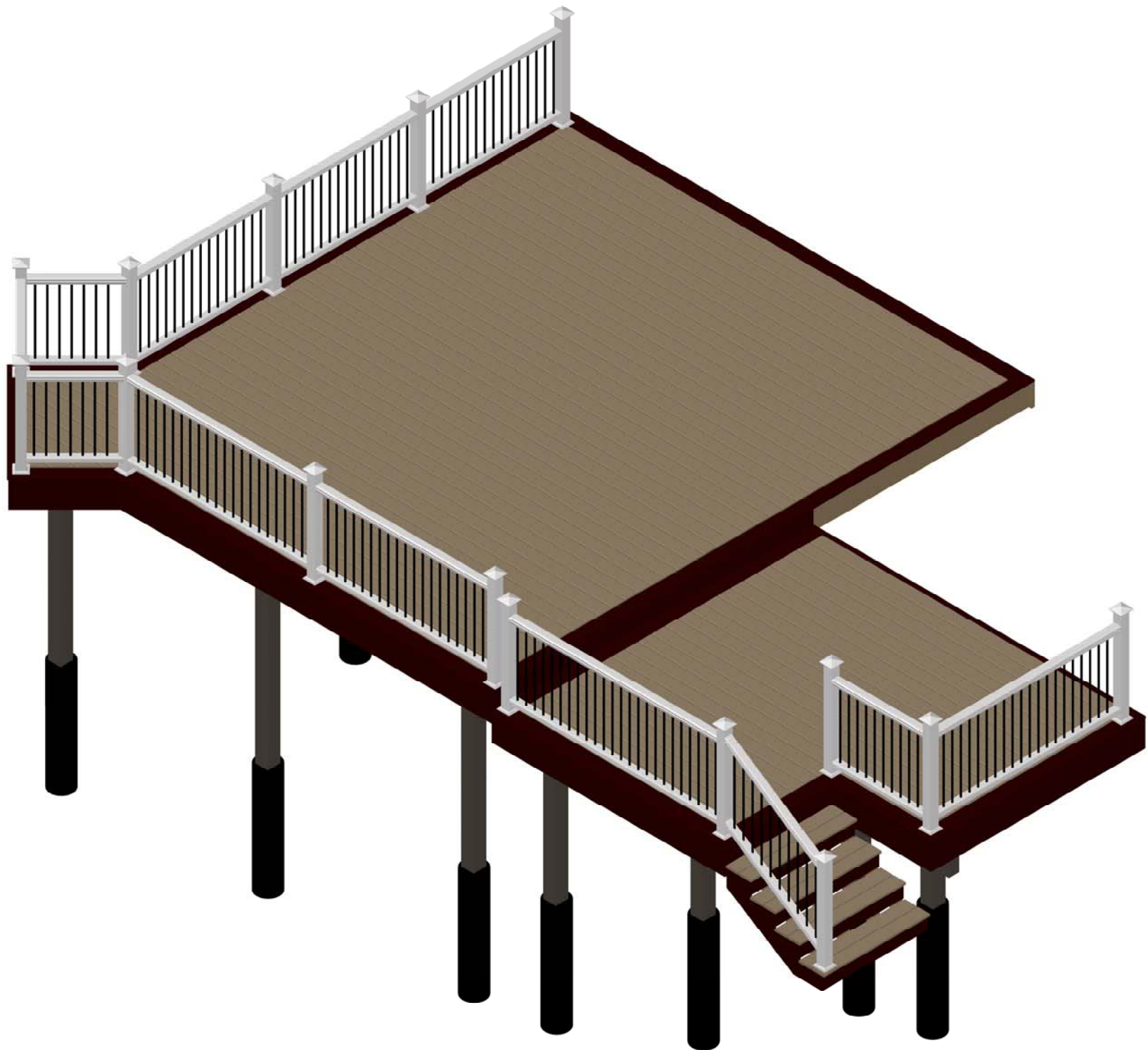

Estimate

Item	color	quant	Pressure Treated Pine	subtotal	Varanda	subtotal	Trex	subtotal		
Piers										
Cement 80lb bag		43	\$ 5.00	215.00	\$ 5.00	215.00	\$ 5.00	215.00		
Sono Tube pier form 10"		10	\$ 7.50	75.00	\$ 7.50	75.00	\$ 7.50	75.00		
Rebar 4' section		20	\$ 2.50	50.00	\$ 2.50	50.00	\$ 2.50	50.00		
Simpson Pier Bracket		10	\$ 25.00	250.00	\$ 25.00	250.00	\$ 25.00	250.00		
Simpson Post Bracket		10	\$ 10.00	100.00	\$ 10.00	100.00	\$ 4.50	45.00		
J-Bolts		10	\$ 1.50	15.00	\$ 1.50	15.00	\$ 1.50	15.00		
Landscaping Fabric		484	\$ 0.65	314.60	\$ 0.65	314.60	\$ 0.65	314.60		
Rubble (optional)		484	\$ 0.65	314.60	\$ 0.65	314.60	\$ 0.65	314.60		
* Excavation costs (possible)		1	\$ 600.00	600.00	\$ 600.00	600.00	\$ 600.00	600.00		
Pressure Treated Lumber										
2x4x16'		21	\$ 7.89	165.69	7	\$ 55.23	7	\$ 55.23		
2x6x16'		7	\$ 8.79	61.53	0	\$ -	0	\$ -		
2x10x12'		15	\$ 16.79	251.85	\$ 16.79	251.85	\$ 16.79	251.85		
2x10x20'		28	\$ 23.78	665.84	\$ 23.78	665.84	\$ 23.78	665.84		
2x12x16'		2	\$ 44.00	88.00	\$ 44.00	88.00	\$ 44.00	88.00		
4x4x16		5	\$ 21.98	109.90	\$ 21.98	109.90	\$ 21.98	109.90		
6 x 6 x 12		8	\$ 44.00	352.00	\$ 44.00	352.00	\$ 44.00	352.00		
5/4 x 6 x 16		70	\$ 12.97	907.90	\$ -	-	\$ -	-		
Balusters 32"	PTP	175	\$ 1.23	215.25	\$ -	-	\$ -	-		
Post Cap	PTP	15	\$ 8.98	134.70	\$ -	-	\$ -	-		
Post Skirt	PTP	15	\$ 5.98	89.70	\$ -	-	\$ -	-		
Composit Decking and Railings										
5/4 x 6 x 12 Grooved	RS - Rope Swing	23	\$ -	-	\$ 26.97	620.31	\$ 47.88	1,101.24		
5/4 x 6 x 12 Square	VL - Vintage Lantern	5	\$ -	-	\$ 26.97	134.85	\$ 47.88	239.40		
5/4 x 6 x 16 Grooved	RS - Rope Swing	34	\$ -	-	\$ 35.97	1,222.98	\$ 63.84	2,170.56		
5/4 x 6 x 16 Square		1	\$ -	-	\$ 35.97	35.97	\$ 63.84	63.84		
5/4 x 6 x 20 Grooved	RS - Rope Swing	6	\$ -	-	\$ 59.28	355.68	\$ 79.80	478.80		
5/4 x 6 x 20 Square	VL - Vintage Lantern	4	\$ -	-	\$ 59.28	237.12	\$ 79.80	319.20		
Fascia- 12" x 8'		2	\$ -	-	\$ 55.97	111.94	\$ -	-		
Fascia- 12" x 12'	VL - Vintage Lantern	7	\$ -	-	\$ 105.32	737.24	\$ 112.79	789.53		
Fascia- 8" x 12'	VL - Vintage Lantern	2	\$ -	-	\$ -	-	\$ 68.69	137.38		
Decorators w/hardware		7	\$ 25.00	175.00	\$ 25.00	175.00	\$ 35.00	245.00		
Post Cap 4x4		15	\$ -	-	\$ 6.47	97.05	\$ 11.09	166.35		
Post Skirt 4x4		15	\$ -	-	\$ 6.99	104.85	\$ 6.59	98.85		
Post Sleeve 39" 4x4		15	\$ -	-	\$ 14.47	217.05	\$ 29.49	442.35		
Top Rail 6'	CW - Classic White	4	\$ -	-	\$ -	-	\$ 48.00	192.00		
Bottem Rail 6'	CW - Classic White	4	\$ -	-	\$ -	-	\$ 55.00	220.00		
TopRail 8'	CW - Classic White	5	\$ -	-	\$ -	-	\$ 62.00	310.00		
Bottem Rail 8'	CW - Classic White	5	\$ -	-	\$ -	-	\$ 67.00	335.00		
Insert Kit	CW - Classic White	5	\$ -	-	\$ -	-	\$ 50.00	250.00		
Insert Kit Stair	CW - Classic White	1	\$ -	-	\$ -	-	\$ 60.00	60.00		
Rail Cut Kit 90 deg	CW - Classic White	1	\$ -	-	\$ -	-	\$ 23.49	23.49		
Bird's Mouth Cut Kit	CW - Classic White	2	\$ -	-	\$ -	-	\$ 24.64	49.28		
RailKit 6' (varanda)		4	\$ -	-	\$ 96.97	387.88	\$ -	-		
RailKit 8' (varanda)		5	\$ -	-	\$ 139.97	699.85	\$ -	-		
RailKit 6' Stair (varanda)		1	\$ -	-	\$ 96.97	96.97	\$ -	-		
Rail 90 cut kit (varanda)		1	\$ -	-	\$ 9.97	9.97	\$ -	-		
Rail 45 cut kit (varanda)		2	\$ -	-	\$ 9.97	19.94	\$ -	-		
Hidden Deck System 50 sqft box		10	\$ -	-	\$ 49.97	499.70	\$ 65.00	650.00		
Hardware										
Flashing (Copper)		2	\$ 56.00	112.00	\$ 56.00	112.00	\$ 56.00	112.00		
Caulking/PI Cement		2	\$ 10.00	20.00	\$ 10.00	20.00	\$ 10.00	20.00		
lag bolts 6"		20	\$ 2.00	40.00	\$ 2.00	40.00	\$ 2.00	40.00		
Simpson Joist Hangers		20	\$ 2.50	50.00	\$ 2.50	50.00	\$ 2.50	50.00		
Simpson Tie Down		20	\$ 0.68	13.60	\$ 0.68	13.60	\$ 0.68	13.60		
Joist hanger nails		2	\$ 15.00	30.00	\$ 15.00	30.00	\$ 15.00	30.00		
Other/nails		1	\$ 65.00	65.00	\$ 65.00	65.00	\$ 65.00	65.00		
Carriage bolt Sets		80	\$ 3.00	240.00	\$ 3.00	240.00	\$ 3.00	240.00		
Deck Screws 25 lbs 2"		2	\$ 100.00	200.00	\$ -	-	\$ -	-		
Deck Screws 25 lbs 3.5"		1	\$ 100.00	100.00	\$ 100.00	100.00	\$ 100.00	100.00		
Deck Screws 5 lbs 2"		1	\$ 30.00	30.00	\$ 100.00	100.00	\$ 30.00	30.00		
Delivery		1	\$ 75.00	75.00	\$ 75.00	75.00	\$ 75.00	75.00		
Other			\$ -	-	\$ -	-	\$ -	-		
Stain/Finish Framing Weather Guard		5	\$ 50.00	250.00	\$ 50.00	250.00	\$ 50.00	250.00		
WaterProofing Crystal clear		3	\$ 30.00	90.00	\$ -	-	\$ -	-		
Material Total			\$	6,467.16		\$	10,316.97	\$	12,769.89	
<i>Retail Sales Tax</i>			\$	452.70		\$	722.19	\$	893.89	
Municipal Fees and Permits			\$	125.00		\$	125.00	\$	125.00	
Architectural Engineers Stamp			\$	1,000.00		\$	1,000.00	\$	1,000.00	
Labor			\$	8,743.36	Labor	\$	8,743.36	Labor	\$	8,743.36
Grand Total			\$	16,788.22	Grand Total	\$	20,907.52	Grand Total	\$	23,532.14
			Pressure Treated Pine			Varanda		Trex		

Note: Estimate is for In Stock Colors and Styles Cost can be subject to change for "Special Order" materials



Australian Timber Oil



Cabot Australian Timber Oil for Decks, Siding, Railings and Outdoor Furniture is a unique blend of oils originally formulated to protect dense tallowood, cambara and merbau from the extreme Australian exposures. Australian Timber Oil penetrates deep into the dense, resin-rich woods to accentuate natural wood depth and patina. Containing a precise blend of superb-grade linseed oil for maximum penetration, long-oil alkyds for durability and pure South American tung oil for color depth and water repellency, Australian Timber Oil delivers three-way oil protection and a beautiful hardwood stain. In addition, complex translucent iron oxide pigments are added to ensure a lasting U.V.-absorbing surface rich with color and dimension. The result after years of development is an advanced-technology treatment of unrivaled performance designed to protect your exotic wood surfaces like never before.



Crystal Clear Waterproofer

An advanced technology, water based silicone coating.-This one of a kind formulation is designed to provide unsurpassed waterproofing protection on a multitude of surfaces by coating the pores of the substrates with silicone.-For use on brick, wood, concrete, and masonry. 1 gallon. Color/Finish: - Crystal Clear finish.

Trex Transcends Decking Colors



Spiced Rum

Lava Rock

Rope Swing

Tree House

Fire Pit

Gravel Path

Vintage Lantern

Trex Transcends Railing Colors

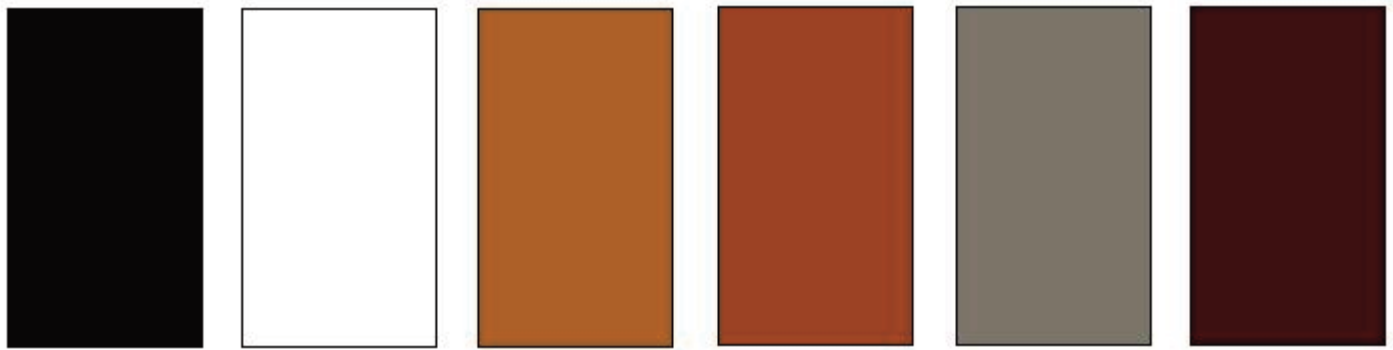

Charcoal Black

Classic White

Tree House

Fire Pit

Gravel Path

Vintage Lantern

Deck O' Rator Baluster Colors



Matte Black

Rust

White

Gloss Black

Bronze

Stainless

Forest

Clay

Copper

Vinyl Skirting Colors



Beige



Clay

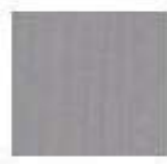

Gray



Sand



Tan



White

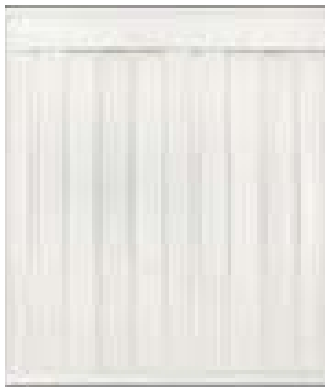

Vinyl Lattice Colors

White Driftwood Gray Woodland Green Forest Green Redwood Cedar Better Than Treated Almond



Veranda Plastic Lattice comes in a variety of colors, including White and several natural-looking wood shades: Forest Green, Woodland Green, Driftwood Gray, Better Than Treated, Almond, Cedar, and Redwood. It's available in multiple sizes, too, to suit a wide range of applications including caps and dividers in matching colors.

Construction Progression

1. We start by taking measurements and working up a building permit package for the municipality. This may involve the acquisition of an architectural engineer's stamp which is only necessary where a particular municipality requires this. Call b4 you dig services are notified for underground locates and service personal from the utility companies may come to your home and chalk mark there underground lines such as gas and or electric and television lines to avoid cutting them and interrupting services as we dig the pier holes. **[3 days to 2 weeks]**
2. Next we layout the piers with marking paint and then dig the holes for them for inspection by the municipality. **[1 day]**
3. After Pier depth **inspection #1**, we pour the piers with cement and allow them to cure for **[7 Days]** other work is done but will not require crews' onsite for the entire 7 day cure time of the piers.
4. Once the piers have cured we start construction of the frame work. Throughout the framing construction process quality control inspections are done by county deck services to ensure the framing was done correctly as well as **inspection #2** is scheduled with the municipality before the decking is installed. **[5 to 7 days]**
5. Next we finish your project by installing the decking, safety railings, grasping handrail (if required), optional skirting /lattice and lighting as well as scheduling a final inspection with the municipality **[5 to 10 days]**

In conclusion, **it can take from 20 to 45 days [3 to 6 weeks] to finish**, constructing your project depending on the municipal requirements and or the options selected in the design. Throughout the construction process you are free to comment on anything you have questions or of concerns about. Each day we clean the debris or organize the material and supply's in order to provide a safe as possible area for the home owner as well as our employees. A field tent 10' x 20' may be setup to provide temporary storage for tools and small material items and or shelter from rain for materials, items packaged in cardboard for example.

Payment

County Deck is paid for labor services. The customer buys the materials directly from the retailer through a retail account, a credit account or by cash sale. In this model the cost is broken down into multiple parts listed below in order of occurrence.

1. Architectural stamped drawings : (if required by your municipality) We have a service in Saugerties ny which provides this for us. The cost is paid directly to them from you, We work with the engineers' architect to ensure the design is compatible with the project as a 3rd party interest.

2. Small Materials Expense Deposit **: This amount is determined by adding the estimated costs for items not to be purchased under a bulk material purchase. This saves money on the cost of materials, for example the cost of copper flashing at Curtis Lumber is \$140.00 for each 20' x 8" roll while the cost for a like same cooper flashing at home depot is \$50.00.

3. Bulk Materials : We set up a purchase order at the retailer chosen according to need availability and cost as well as the method for payment (retailer account). The customer then makes payment directly for bulk materials.

4. Labor : when you are satisfied the work agreed has been completed. A final statement, Invoice and credit memo are included with receipts. Any expense deposit amounts not account for in receipts as well as any credits from returned or unused materials is subtracted from the Labor balance.

***Note: in some instances there may be a need for additional small expense deposit capital in such cases an accounting for the original small expense deposit is made and the reasoning for the additional funds are discussed.*

We at county deck want our customers in as much control of their investment as possible, to help our customers feel they are spending there money wisely, feel they have received quality work at a bargain price and have increased the value of their home.

As qualified professionals who contract to give our customers security and piece of mind that construction of there additional living environment is safe for them, their families and there guests, we take this responsibility to ensure this is true.